

RVM80-D

rev:1-31-2022

Build-To Sheet

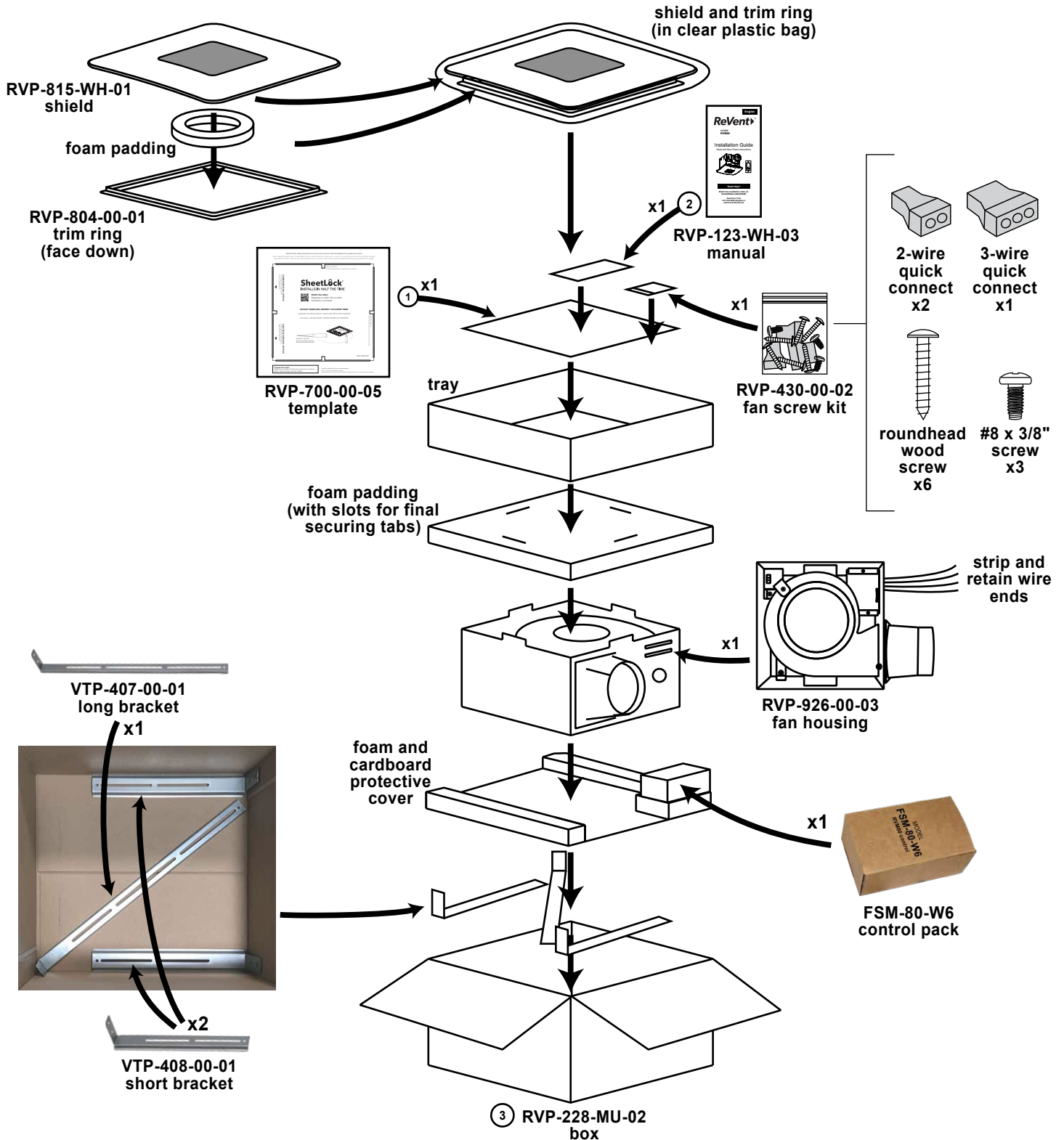

1: ReVent_80CFM_template_060921.ai

2: RVM80-D_manual_013122.ai

3: RVM80-D_box_110421.ai

RVM80-D



RVP-228-MU-02
box
(shown closed and sealed)

RVP-815-WH-01

Label Placement (bottom of shield)

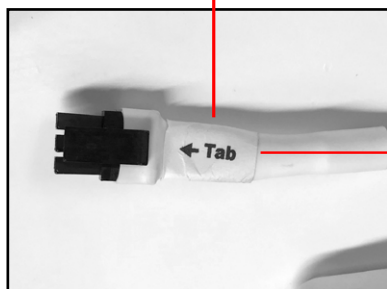

1

← Tab

FSM-80-W6

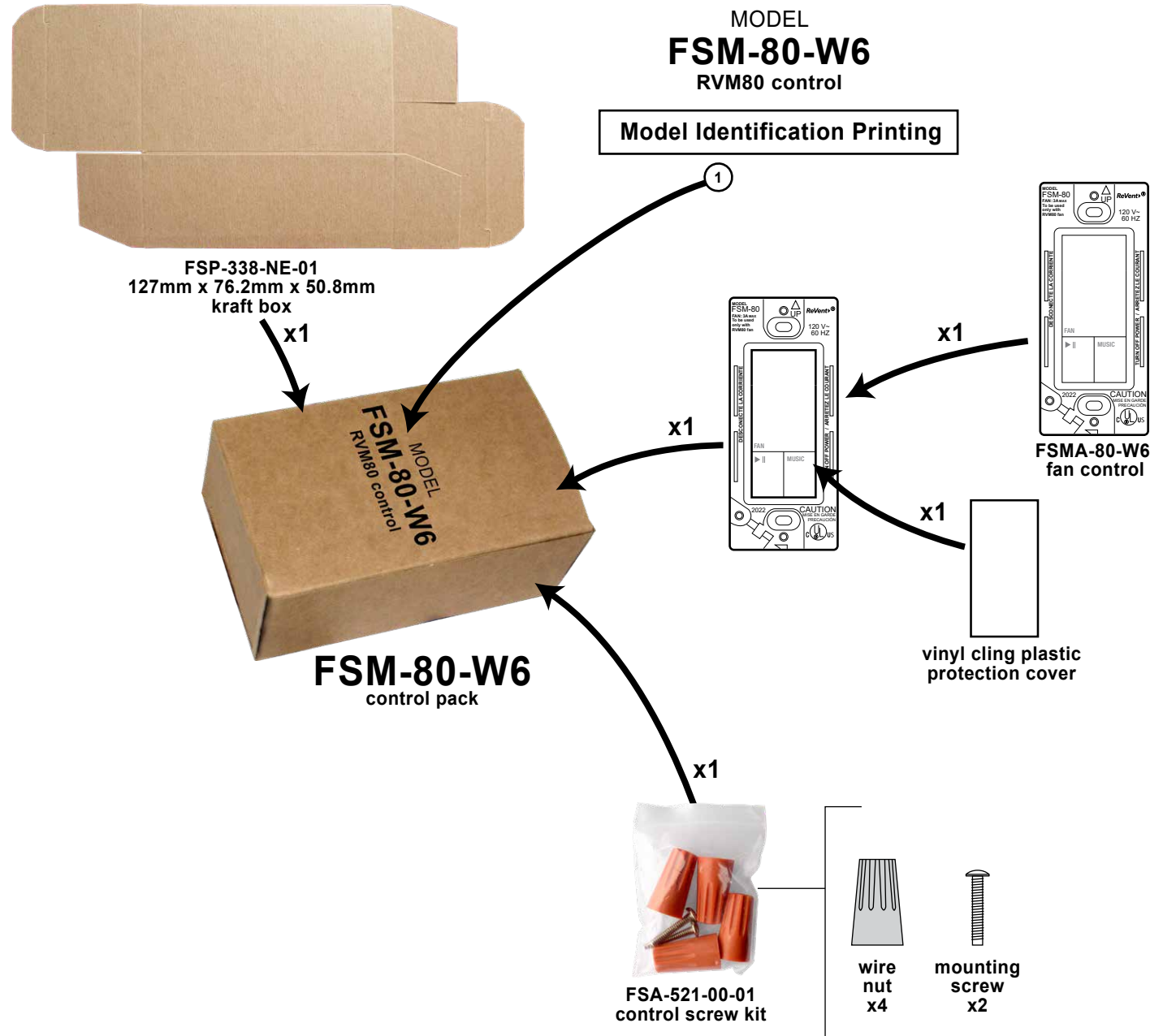

FSMA-80-W6

MODEL
FSM-80

FAN: 3A MAX
To be used
only with
RVM80 fan

ReVent®



120 V~
60 HZ

Laser Printing

1

DESCONECTE LA CORRIENTE

Plastic Printing

2

FAN



MUSIC

Button Printing

3

Date Code (YYWW)

Laser Printing

1

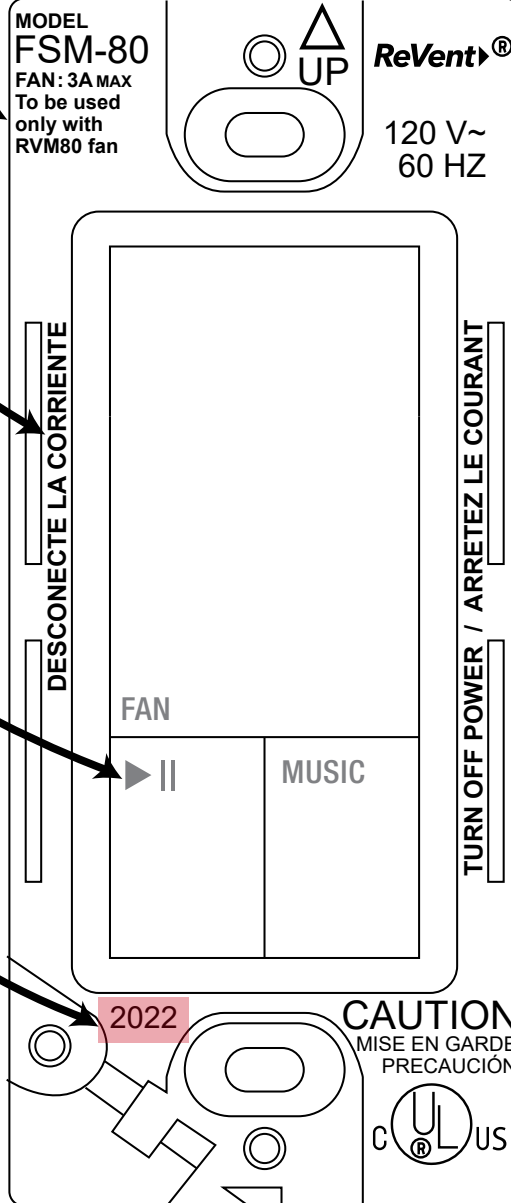

TURN OFF POWER / ARRETEZ LE COURANT

CAUTION
MISE EN GARDE
PRECAUCIÓN



Plastic Printing

2

FSMA-80-W6



Laser printing or label printing

ReVent® FSM-80
product of GTR Technologies Inc.
USA and international patents pending.
Electrical Input: 120 volts @ 60Hz
Maximum Fan Load: 3 Amps
This switch is only to be used with
ReVent fan model RVM80
**Must Be Mounted Inside A Code
Approved Electrical Outlet Box**
FCC ID: 2AHXP-FSM80
Canada IC : 21435-FSM80



FAN
POWER (HOT)
NEUTRAL

RVP-926-00-03

Label Placement

Date Code (YY-MM)

ReVent
VENTILATION FAN VENTILADOR

| MODEL | V | Hz | A | UL W | CFM | SONE | DATE |
|-------|-----|----|------|------|-----|------|-------|
| RVM80 | 120 | 60 | 0.18 | 20 | 80 | 0.9 | 20-09 |

- DISCONNECT POWER AT SERVICE ENTRANCE BEFORE CLEANING OR SERVICING
- SUITABLE FOR CEILING INSTALLATION OVER TUB OR SHOWER
- SUITABLE FOR WALL INSTALLATION IN INTERIOR WALL
- NOT FOR USE IN COOKING AREA
- THERMALLY PROTECTED
- SEE INSTALLATION INSTRUCTIONS
- DESCONECTE LA ALIMENTACIÓN EN LA ENTRADA DE SERVICIOS ANTES DE EMPRENDER TAREAS DE LIMPIEZA O DE MANTENIMIENTO
- APTO PARA INSTALAR POR ENCIMA DE LA BAÑERA O DUCHA
- APTO PARA INSTALAR EN PAREDES INTERIORES
- NO DEBE USARSE EN LA COCINA
- POSEE PROTECCIÓN TÉRMICA
- VER INSTRUCCIONES DE INSTALACIÓN

This device complies with Part 15 of the FCC Rules and RSS-247 of Canada. Operation is subject to the following two conditions: (1) this device may not cause harmful interference, and (2) this device must accept any interference received, including interference that may cause undesired operation.

Este dispositivo cumple con la parte 15 de las Reglas de la FCC y RSS-247 de Industry Canada. El funcionamiento está sujeto a las dos condiciones siguientes: (1) Este dispositivo no puede causar interferencias perjudiciales y (2) este dispositivo debe aceptar cualquier interferencia que pueda causar un funcionamiento no deseado.

FCC ID: 2ARXP-RVM80
Canada IC: 21435-RVM80

WARNING: Acceptable for use over a bathtub or shower when installed in a GFCI protected branch circuit. **CAUTION:** To reduce the risk of injury to persons, install fan at least 2.5m (8.2') above the floor. To reduce risk of fire and to properly exhaust air, be sure to duct air outside. DO NOT vent exhaust air into spaces within walls or ceilings of attic, crawl spaces, or garages.

ADVERTENCIA: apto para usar sobre una bañera o ducha cuando se instala en un circuito derivado, protegido por un interruptor diferencial (GFCI, por sus siglas en inglés). **PRECAUCIÓN:** para reducir el riesgo de lesiones personales, instale el ventilador al menos a 2.5 m (8.2') sobre el piso. Para reducir el riesgo de incendio y para extraer adecuadamente el aire, asegúrese de canalizar el aire hacia el exterior. NO ventile el aire de escape en espacios entre paredes, bajo techos, en áticos, en sótanos o en garajes.

GTR Technologies Inc.
All Right Reserved, USA and
International Patents Pending



RVP-829-YL-01
4" damper cover

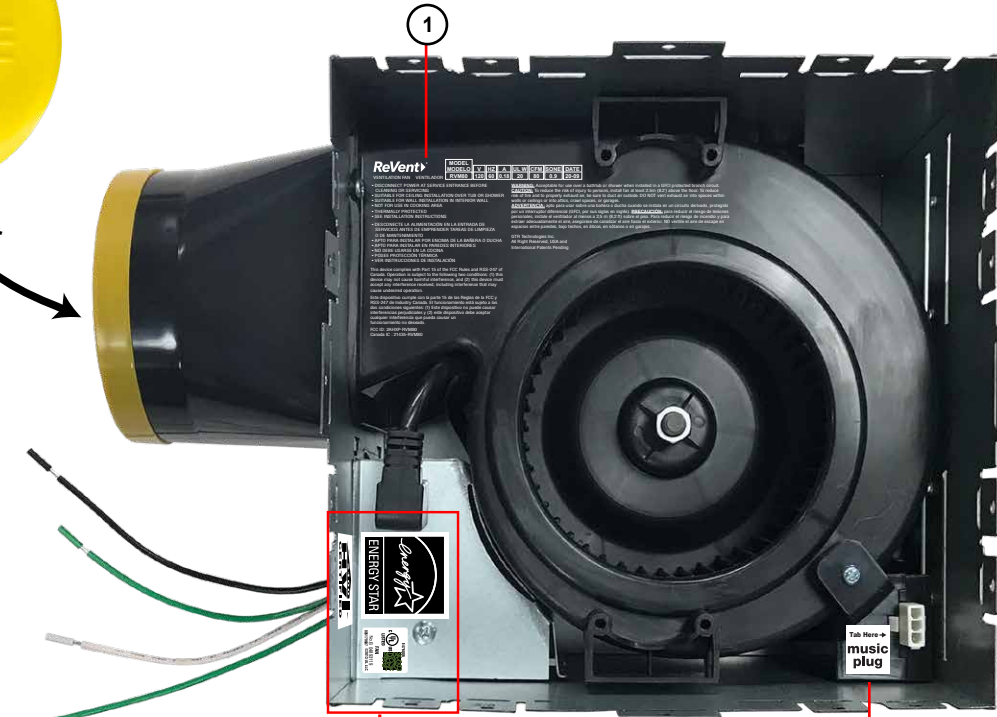

2



3



4

Tab Here →
music
plug

1: RVM80-D_laser-printing_013122.ai

2: hvi_label_120318.ai

3: energy_star_label_120318.ai

4: music_plug_label_072921.ai

RVP-926-00-03

Label Placement (side of housing)

Model: RVM80
Brand: ReVent
Product: Smart Phone Fan

FCC ID: 2AHXP-RVM80
Canada IC : 21435-RVM80

This device complies with Part 15 of the FCC Rules and RSS-247 of Canada. Operation is subject to the following two conditions: (1) this device may not cause harmful interference, and (2) this device must accept any interference received, including interference that may cause undesired operation.

Este dispositivo cumple con la parte 15 de las Reglas de la FCC y RSS-247 de Industry Canada. El funcionamiento está sujeto a las dos condiciones siguientes: (1) Este dispositivo no puede causar interferencias perjudiciales y (2) este dispositivo debe aceptar cualquier interferencia que pueda causar un funcionamiento no deseado.



RVP-926-00-03

Label Placement (bottom of motor)

CAUTION: This Motor APB21-4T should be used with housing RVXX80 only.
ATTENTION : Ce moteur APB21-4T doit être utilisé uniquement avec le boîtier RVXX80
PRECAUCIÓN: Este Motor APB21-4T deberá utilizarse solo con la cubierta RVXX80.

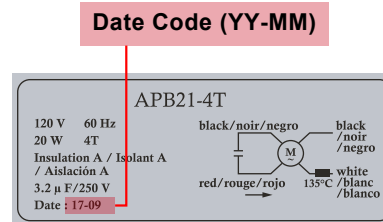

REV LOG

| REV DATE | MODEL/PART NO. | DISCRIPTION |
|-----------|----------------|--|
| 6/22/2021 | -- | Original build |
| 6/23/2021 | RVM80-D | Added foam padding for shield base (page 1) |
| 6/28/2021 | RVP-926-00-01 | Updated specs on fan laser printing (page 7) |
| | RVP-228-MU-01 | Updated specs on box (page 1-2) |
| | RVP-123-WH-01 | Updated specs in manual and updated "Using Phone's Assistant", "Voice Control", and "Make or Take a Call and Text" sections (page 1) |
| 7/8/2021 | RVP-123-WH-01 | Updated manual (put "pick up" and "hang up" commands back in) (page 1) |
| 7/22/2021 | RVP-123-WH-01 | Updated manual (added more text describing the "hang up" function, added UL required text to the warnings section for the control) (page 1) |
| 7/23/2021 | RVP-123-WH-01 | Updated manual (updated music plug illustrations) (page 1) |
| 7/26/2021 | RVP-123-WH-01 | Updated manual (added FCC text) (page 1) |
| 8/2/2021 | RVP-815-WH-01 | Added "Tab" label to shield plug cable (page 3) |
| | RVP-926-00-01 | Added "Tab Here" to music plug label (page 7) |
| 8/4/2021 | RVP-926-00-01 | Added FCC text to laser printing, adjusted position of warning text to match factory sample (page 7) |
| 8/25/2021 | RVP-123-WH-01 | Updated manual (added FCC ID #s) (page 1) |
| | FSMA-80-W6 | Added FCC ID #s to laser printing (page 6) |
| | RVP-926-00-01 | Added FCC ID #s to laser printing (page 7) |
| 8/30/2021 | RVP-228-MU-01 | Updated box (changed bottom stripe from blue to green, added "Stream..." above Spotify, replaced bullets from side of box with info on the control, replaced /install QR code with /video1, bolded "SMARTPHONE CONNECTED FAN" on 4 box sides) (page 1-2) |
| 8/31/2021 | RVP-228-MU-01 | Updated box (changed "Hey Google" to "Hey Siri" on 2 box sides) (page 1-2) |
| 9/3/2021 | RVP-123-WH-01 | Updated specs in manual (added 0.25 pressure specs, removed HVI *) (page 1) |
| | RVP-228-MU-01 | Updated box (corrected a spelling mistake) (page 1-2) |
| | RVP-926-00-01 | Updated fan laser printing (changed "W" to "UL W") (page 7) |
| 9/8/2021 | FSMA-80-W6 | Updated FCC ID#s (removed the second dash in the number) (page 6) |
| 9/10/2021 | RVP-123-WH-01 | Updated specs in manual (changed the wat spec) (page 1) |
| | RVP-228-MU-01 | Updated box (changed the wat spec) (page 1-2) |
| | RVP-926-00-01 | Updated specs on fan laser printing (changed the wat spec) (page 7) |
| 9/24/2021 | RVP-123-WH-01 | Updated manual (R40 changed to R-50) (page 1) |
| | RVP-228-MU-01 | Updated box (R40 changed to R-50) (page 1-2) |
| 11/4/2021 | RVP-123-WH-02 | Manual part # updated from -01 to -02 (page 1) |
| | RVP-430-00-02 | Screw kit part # updated from -01 to -02 (page 1) |
| | RVP-228-MU-02 | Updated box (added patent claim, added box part# to bottom of box) (page 1-2) |
| | RVP-926-00-02 | Fan housing part # updated from -01 to -02 (page 7) |
| 1/31/2022 | RVP-926-00-03 | Updated fan laser printing (changed RSS-210 to RSS-247) (page 7) |
| | | Added FCC label to side of fan housing, also added new page to build-to sheet for this (page 8) |
| | RVP-123-WH-03 | Updated manual (changed RSS-210 to RSS-247) (page 1) |