

RVS150

rev:11-8-2021

Build-To Sheet

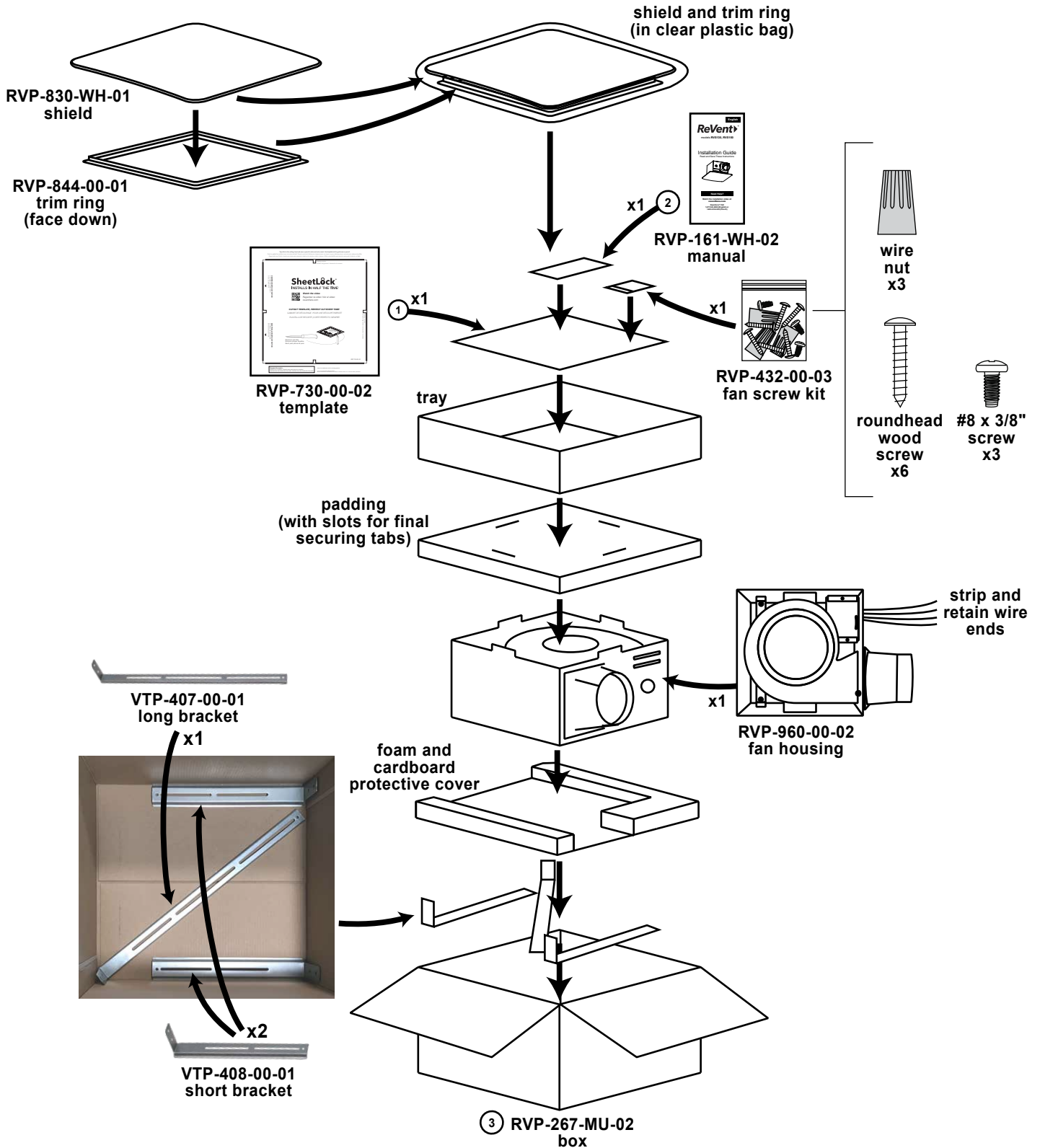

1: ReVent_130-150CFM_template_051921.ai

2: RVS130-150_manual_110821.ai

3: 150CFM_wholesale-box_110821.ai

RVS150



performance at 6" ducting

Static Pressure (in wg)	Airflow (cfm)	Sound (sones)	Energy (watts)	Duct Size
RVS150, RVSH150				
0.1	150	1.3	37.5	6 in
0.25	116		36.7	6 in
RVL150, RVLH150				
0.1	150	1.2	37.5	6 in
0.25	111		36.7	6 in

ReVent
with **SheetLock**
INSTALLS IN HALF THE TIME

150 CFM **1.3** SONE

RVS150 Ventilation Fan
 RVSH150 Ventilation Fan Humidity Sensing

150 CFM **1.2** SONE

RVL150 Ventilation Fan LED Lighting
 RVLH150 Ventilation Fan LED Lighting Humidity Sensing

Housing / Alojamiento
10 1/2 x 10 1/2 x 6 1/4 in
(26.7 x 26.7 x 17.1 cm)

Shield / Escudo
13 1/8 x 13 1/8 in
(34 x 34 cm)

Duct / Conducho
6 in diameter
(15.24 cm)

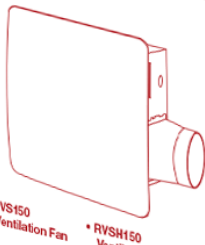

• **RVS150** Ventilation Fan

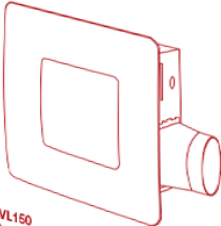

• **RVLH150** Ventilation Fan LED Lighting Humidity Sensing (control included)



Saves energy

*Based on fractional-pitch fan mounting systems

ReVent
with **SheetLock**
INSTALLS IN HALF THE TIME



Watch the Installation
Original instruction
www.reventfans.com

Remodel / Retrofit Installation

- Never needs attic access
- Installs room-side in half the time - saving labor/cost
- Mounts directly to sheetrock, no mounting screws needed

New Construction Installation

- J-Box hangers included
- Mount fan body during framing stage



mark here
(mark on both sides of box)

RVP-267-MU-02
box
(shown closed and sealed)

RVP-960-00-02

Label Placement

Date Code (YY-MM)

Note: 6" damper covers not yet made, tape with damper label until covers are made

WARNING:
PLEASE REMOVE THE ADHESIVE TAPE BEFORE CONNECTING THE DUCT.

AVERTISSEMENT :
VEUILLEZ RETIRER CE RUBAN ADHÉSIF AVANT DE BRANCHER LA TUYAUTERIE.

ADVERTENCIA:
QUITE LA CINTA ADHESIVA ANTES DE CONECTAR EL CONDUCTO.



RVP-831-WH-01
6" damper cover

ReVent® VENTILATION FAN
VENTILADOR

MODEL MODELO	V	HZ	A	UL W	CFM	SONE	DATE
RVS150	120	60	0.32	40	150	1.3	20-09

- DISCONNECT POWER AT SERVICE ENTRANCE BEFORE CLEANING OR SERVICING
- SUITABLE FOR CEILING INSTALLATION OVER TUB OR SHOWER
- SUITABLE FOR WALL INSTALLATION IN INTERIOR WALL
- NOT FOR USE IN COOKING AREA
- THERMALLY PROTECTED
- SEE INSTALLATION INSTRUCTIONS

- DESCONECTE LA ALIMENTACIÓN EN LA ENTRADA DE SERVICIOS ANTES DE EMPRENDER TAREAS DE LIMPIEZA O DE MANTENIMIENTO
- APTO PARA INSTALAR POR ENCIMA DE LA BAÑERA O DUCHA
- APTO PARA INSTALAR EN PAREDES INTERIORES
- NO DEBE USARSE EN LA COCINA
- POSEE PROTECCIÓN TÉRMICA
- VER INSTRUCCIONES DE INSTALACIÓN

WARNING: Acceptable for use over a bathtub or shower when installed in a GFCI protected branch circuit.

CAUTION: To reduce the risk of injury to persons, install fan at least 2.5m (8.2') above the floor. To reduce risk of fire and to properly exhaust air, be sure to duct air outside. DO NOT vent exhaust air into spaces within walls or ceilings or into attics, crawl spaces, or garages.

ADVERTENCIA: apto para usar sobre una bañera o ducha cuando se instala en un circuito derivado, protegido por un interruptor diferencial (GFCI, por sus siglas en inglés). **PRECAUCIÓN:** para reducir el riesgo de lesiones personales, instale el ventilador al menos a 2.5 m (8.2 ft) sobre el piso. Para reducir el riesgo de incendio y para extraer adecuadamente el aire, asegúrese de canalizar el aire hacia el exterior. NO ventile el aire de escape en espacios entre paredes, bajo techos, en áticos, en sótanos o en garajes.

GTR Technologies Inc.



1: RVS150_laser-printing_110821.ai	3: energy_star_label_120318.ai
2: hvi_label_120318.ai	

RVP-960-00-02

Label Placement (bottom of motor)

CAUTION: This Motor APB40-4T should be used with housing RVXX150 only.
ATTENTION : Ce moteur APB40-4T doit être utilisé uniquement avec le boîtier RVXX150
PRECAUCIÓN: Este Motor APB40-4T deberá utilizarse solo con la cubierta RVXX150.

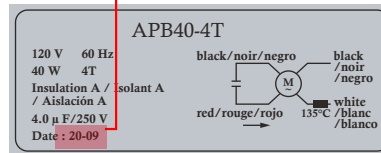

REV LOG

REV DATE	MODEL/PART NO.	DISCRIPTION
5/19/2021	--	Original build
5/21/2021	RVP-960-00-01	Updated specs on fan housing laser printing (page 3)
	RVP-960-00-01	Updated specs on motor labels (page 4)
	RVP-161-WH-01	Updated manual with new specs (page 1)
	RVP-267-MU-01	Updated box art with new specs (page 1)
7/7/2021	--	Updated foam and cardboard protective cover configuration (page 1)
	--	Updated padding to remove the corner cutout (page 1)
10/21/2021	RVP-161-WH-01	Updated manual (corrected performance specs [Sone, W, CFM] to match HVI report and removed HVI *, R40 changed to R-50) (page 1)
	RVP-267-MU-01	Updated box (corrected performance specs [Sone, W, CFM] to match HVI report and removed HVI *, R40 changed to R-50) (page 1-2)
11/8/2021	RVP-161-WH-02	Manual part # updated from -01 to -02 (page 1)
	RVP-432-00-03	Screw kit part # updated from -02 to -03 (page 1)
	RVP-267-MU-02	Updated box (added patent claim, added box part# to bottom of box) (page 1-2)
	RVP-960-00-02	Updated fan laser printing (corrected performance specs [Sone, W, CFM] to match HVI/UL reports) (page 3)