

## Build-To Sheet

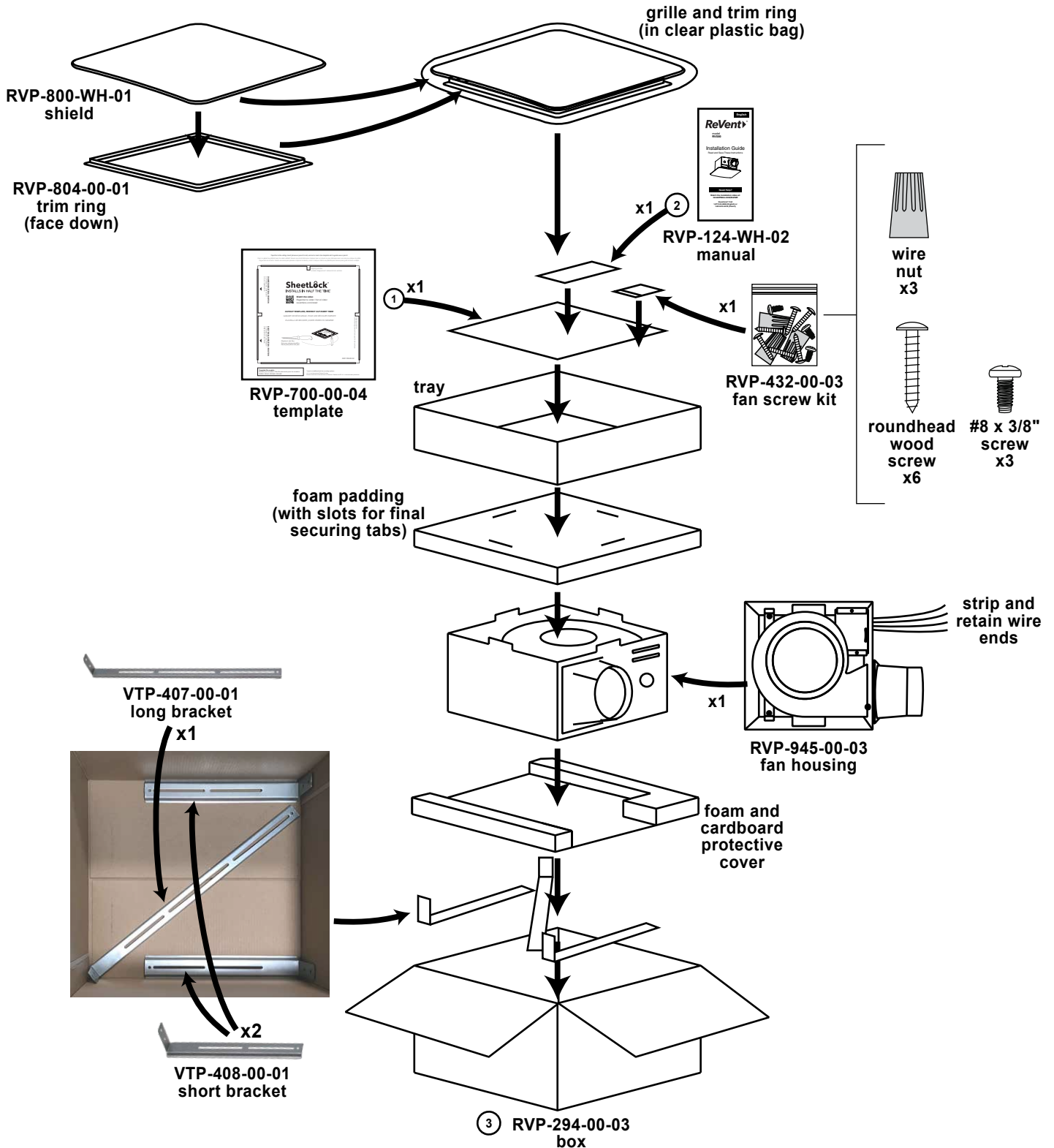

1: ReVent\_80CFM\_template\_051821.ai

2: RVS80-DC\_manual\_110321.ai

3: RVS80-DC\_box\_110321.ai

# RVS80-DC



RVP-294-00-03  
box  
(shown closed and sealed)

# RVP-945-00-03

## Label Placement

Date Code (YY-MM)

**ReVent** VENTILATION FAN  
VENTILATEUR D'AÉRATION

MODEL	V	Hz	A	UL W	CFM	SONE	DATE
MODELE	V	Hz	A	UL W	CFM	SONE	DATE
RVS80	120	60	0.19	20	80	0.7	20-09

• DISCONNECT POWER AT SERVICE ENTRANCE BEFORE CLEANING OR SERVICING  
 • SUITABLE FOR CEILING INSTALLATION OVER TUB OR SHOWER  
 • SUITABLE FOR WALL INSTALLATION IN INTERIOR WALL  
 • NOT FOR USE IN COOKING AREA  
 • THERMALLY PROTECTED  
 • SEE INSTALLATION INSTRUCTIONS  
 • DÉBRANCHEZ L'ALIMENTATION AU PANNEAU ÉLECTRIQUE AVANT LE NETTOYAGE OU L'ENTRETIEN  
 • CONVIENT À UNE INSTALLATION AU PLAFOND AU-DESSUS D'UNE BAINOIRE OU D'UNE DOUCHE  
 • CONVIENT À UNE INSTALLATION SUR UN MUR INTÉRIEUR  
 • USAGE NON DESTINÉ À UNE ZONE DE CUISSON  
 • PROTECTION THERMIQUE  
 • CONSULTEZ LES INSTRUCTIONS D'INSTALLATION

GTR Technologies Inc.

**WARNING:** Acceptable for use over a bathtub or shower when installed in a GFI protected branch circuit. **CAUTION:** To reduce the risk of injury to persons, install fan at least 2.5m (8.22) above the floor. To reduce risk of fire and to properly exhaust air, be sure to duct air outside. DO NOT vent exhaust air into spaces within walls or ceilings or into attics, crawl spaces, or garages.  
**AVERTISSEMENT:** S'utiliser au-dessus d'une baignoire ou d'une douche avec installation à un circuit de dérivation protégé à un DDT. **ATTENTION:** Pour réduire les risques de blessures, installez le ventilateur à une distance minimale de 2,5 m (8,22 pi) du sol. Pour réduire les risques d'incendie et pour évacuer adéquatement l'air, assurez-vous d'orienter la conduite d'air vers l'extérieur. N'évacuez PAS l'air dans un mur, un plafond, un grenier, un vide sanitaire ou un garage.



RVP-829-YL-01  
4" damper cover

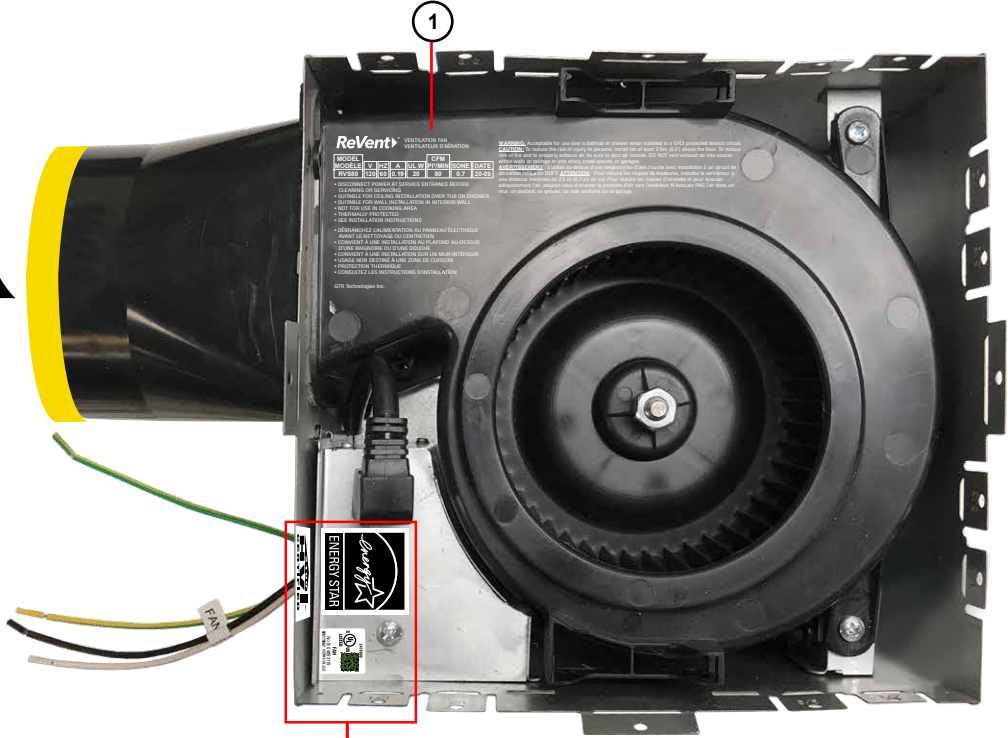

2



3



# RVP-945-00-03

## Label Placement (bottom of motor)

**CAUTION:** This Motor APB21-4T should be used with housing RVXX80 only.

**ATTENTION :** Ce moteur APB21-4T doit être utilisé uniquement avec le boîtier RVXX80

**PRECAUCIÓN:** Este Motor APB21-4T deberá utilizarse solo con la cubierta RVXX80.

Date Code (YY-MM)

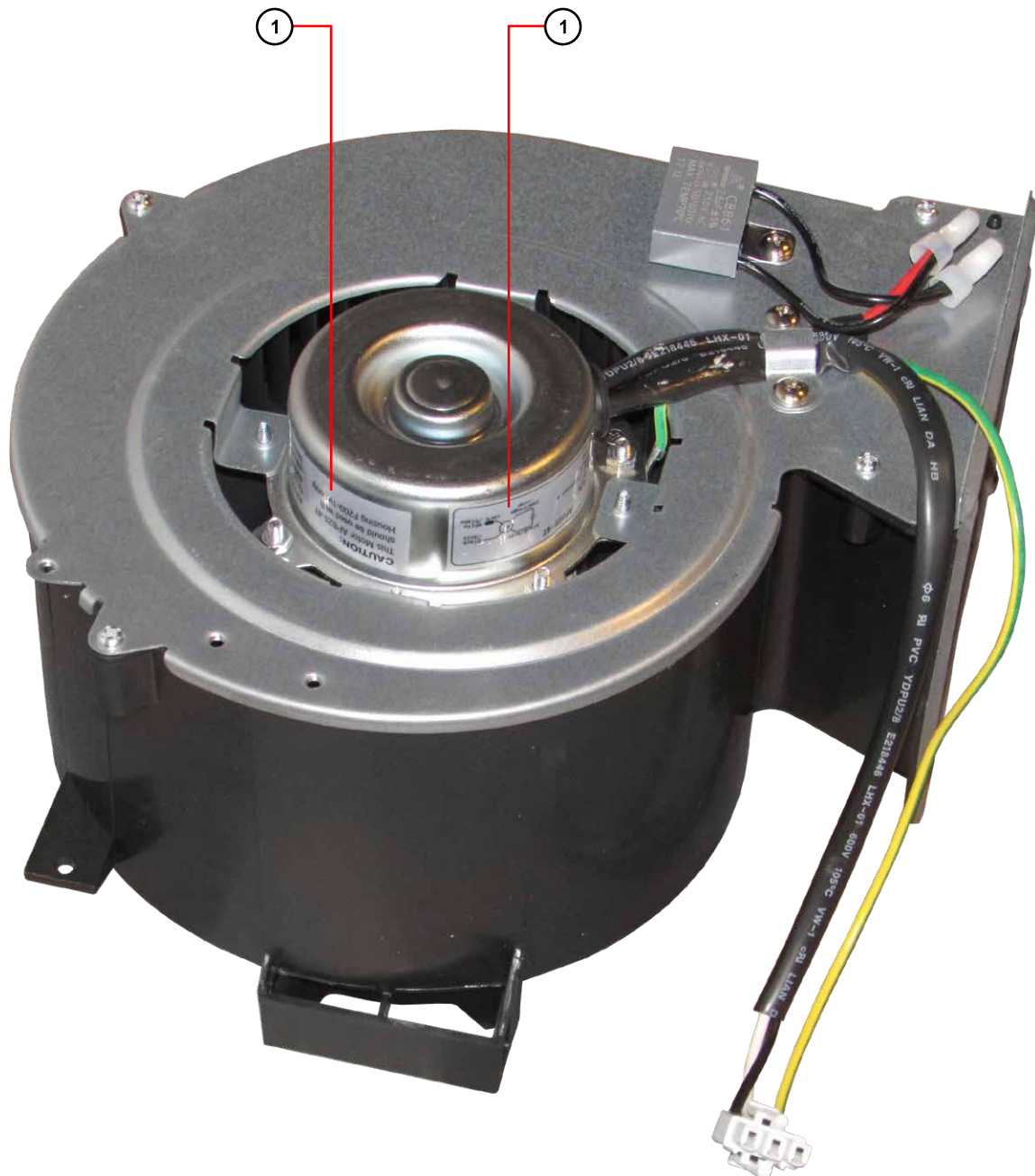
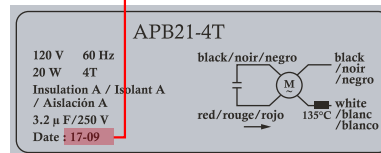

---

# REV LOG

---

REV DATE	MODEL/PART NO.	DISCRIPTION
6/7/2019	--	Original build
7/25/2019	RVP-294-00-01	Updated box art file (page 1-2)
7/14/2021	RVP-294-00-02	Updated box art file (added @s to SheetLock and ReVent, corrected shield drop shadows, added * to "installs in half the time", removed feature callout in top front corner of box fronts) (page 1-2)
	RVP-700-00-04	Updated template (added * to "installs in half the time") (page 1)
	RVP-432-00-02	Updated screw kit (page 1)
	RVP-124-WH-01	Switched to a dedicated RVS80-DC only manual (page 1)
	RVP-945-00-02	Updated fan laser printing to include sones and added an @ to ReVent logo) (page 3)
	RVP-945-00-02	Updated motor labels to match current versions (page 4)
7/15/2021	RVP-294-00-02	Updated box art file (removed "-DC" from the shown part #) (page 1-2)
7/16/2021	RVP-294-00-02	Updated box art file (changed "grille" to "shield" on side of box) (page 1-2)
9/14/2021	RVP-124-WH-01	Updated manual (corrected performance specs [Sone, W, CFM] to match HVI report and removed HVI *) (page 1)
	RVP-294-00-02	Updated box (corrected performance specs [Sone, W, CFM] to match HVI report and removed HVI *) (page 1-2)
	RVP-945-00-02	Updated fan laser printing (corrected performance specs [Sone, W, CFM] to match HVI/UL reports) (page 3)
9/27/2021	RVP-124-WH-01	Updated manual (adaptor removed) (page 1)
11/3/2021	RVP-124-WH-02	Manual part # updated from -01 to -02 (page 1)
	RVP-432-00-03	Screw kit part # updated from -02 to -03 (page 1)
	RVP-294-00-03	Updated box (added patent claim, added box part# to bottom of box) (page 1-2)
	RVP-945-00-03	Fan housing part # updated from -02 to -03 (page 3)